

REVISIONS		
Rev.	Date	By

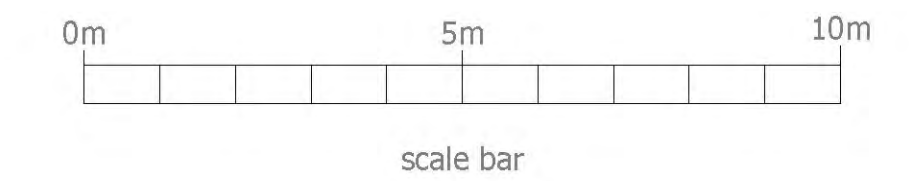

Elevation DD 1:100



**planningissues**  
TOWN PLANNING AND ARCHITECTURAL DESIGN  
Gideon Lemberg RIBA  
Design Director  
Millstream House \* Parkside  
Ringwood \* Hampshire BH24 3JG  
Telephone: (01425) 462109  
Fax: (01425) 462101  
E-mail: design@planningissues.co.uk

Client  
**Churchill**  
Retirement Living

Project Title  
PROPOSED CRL HOUSING  
193 & 195 Thorpe Hall Avenue  
Thorpe Bay,  
Essex, SS1 3AP

Drawing Title  
*Elevation Sheet 4*

Scale 1:100 @ A1 Date SEPT 2017  
Drawn JM Checked -  
Drawing No. Rev.  
**40028-TB-PL18**

**Material Schedule:**

- ① MAIN FACING BRICKWORK - BRICK BLEND: Red Brick, (0176 Grosvenor Autumn Flame: 65%, 4009 Bexhill Dark: 35%), Mortar: Natural
- ② CLADDING - Marley Eternit Cedral Cladding - C51 Silver Grey
- ③ ROOF TILE 1 - Marley Eternit Edgemere - Smooth Grey
- ④ WINDOWS - White UPVC windows throughout
- ⑤ BOUNDARY TREATMENT - See Site Plan drawing
- ⑥ RAINWATER GOODS - Black UPVC

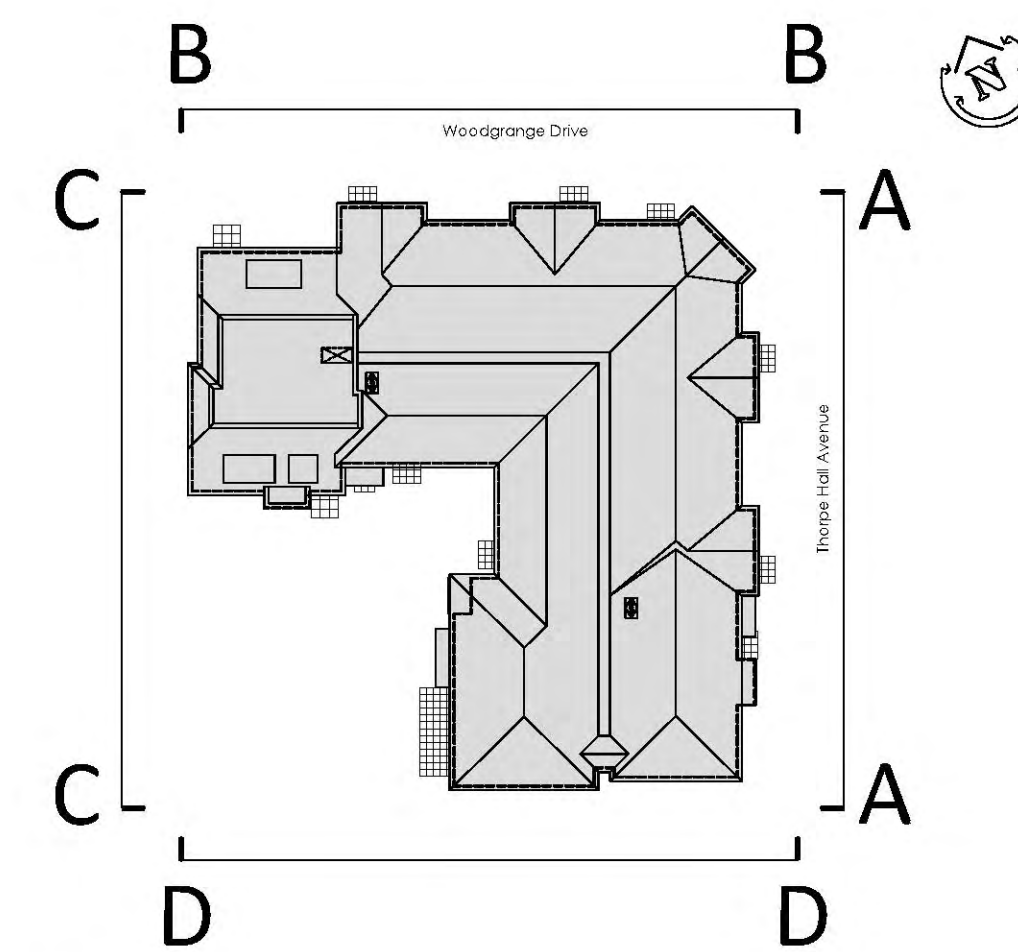

Key Map